



ESDA-402-21



The ESDA Series is engineered for medium to long-term constant low humidity storage of 1%RH. It is equipped with a patented U 2000 Drying Unit.

Humidity, temperature and alarm functions are displayed and can be adjusted on a digital display.

The circulation of air in the cabinet is regulated by an internal fan.

Proven in use around the world, the unique design of the ESDA-402 is highly energy efficient, representing a significant cost advantage to our customers.

The ESDA version is ESD safe. The surfaces of the cabinet are not chargeable. Acrylic body $10^7 \Omega/\text{sq}$.

The SD-151-21 is ideal for the moisture-proof and anti-oxidation storage of wide-ranging technologies and conforms with IPC/JEDEC J- Std 033C.



Features

Accuracy of sensor RH% & T°C
Lockable doors
ESD safe design
Shelves

Door alarm

Drying unit
ESD bonding point
21 series digital panel

Pre mounted holes
Transport
Power supply

+/- 3%, +/- 1 °C

2 doors locked with key

The surfaces of the cabinet are not chargeable. Acrylic body $10^7 \Omega/\text{sq}$
5 height adjustable chromium plated steel shelves connected with conductive frame $10^3 \Omega/\text{sq}$.

Every door is equipped with a switch which triggers the humidity or door alarm if the preset value is exceeded

U 2000 Drying Unit

ESD wristband can be connected with the cabinet

Very convenient settings of RH%, temperature, alarm and calibration functions

For nitrogen unit

Cabinet equipped with ESD castors

5 meter cable with IEC plug

Benefits

Options availability
Maintenance
Highly energy sufficient
Recovery time after door opening
Datalogging
Clear Polycarbonate material
IPC

N2 (Auto) Flow, SMD reel racks, etc.

The cabinet is maintenance free

Average power consumption 35 W/h

<45 min

With Rotronic datalogger

Transparent and easy to see contents

According to IPC-Jstd 033C



Totech Europe BV
De Linge 28
NL-8253 PJ Dronten
www.totech.eu.com

Phone: +31 (0) 321 330239
Fax: +31 (0) 321 330254
K.v.K: Lelystad 390 86417
E-Mail: info@totech.eu.com

V.A.T.: NL813341887B01
IBAN :NL83Rabo0145683443
B.I.C./Swift: RaboNL2U
Bank: 1456.83.443



Technical Data Cabinet

External dimensions:	(W x H x D) 574 x 1485(1690) x 517 mm
Internal dimensions:	(W x H x D) 560 x 1480 x 480 mm
Weight:	60 kg
Weight on shelf:	30 kg
Max. loading capacity:	100 kg
Frame:	Aluminium ESD coated
Body:	ESD-Polycarbonate
Shelves (W x D):	4 long 460 x 490 mm adjustable, 1 short 460 x 380 mm adjustable
Volume:	386 L
Voltage:	230 V, 50 Hz 120 V, 60 Hz (optional)
Power consumption:	35W/h
Grounding:	Class 1, hard grounded
RH%:	Drying 1 - 2%*

*(depending on number of door openings)

Technical Data N² Auto Flow

N ² Auto Flow:	N ² connection pressure:	1 – 6 bar
	N ² Standby- quantity:	0 – 25 L/min
	N ² (Purge):	0 – 25 L/min
	(Purge-Time):	0 – 99 min



Performance

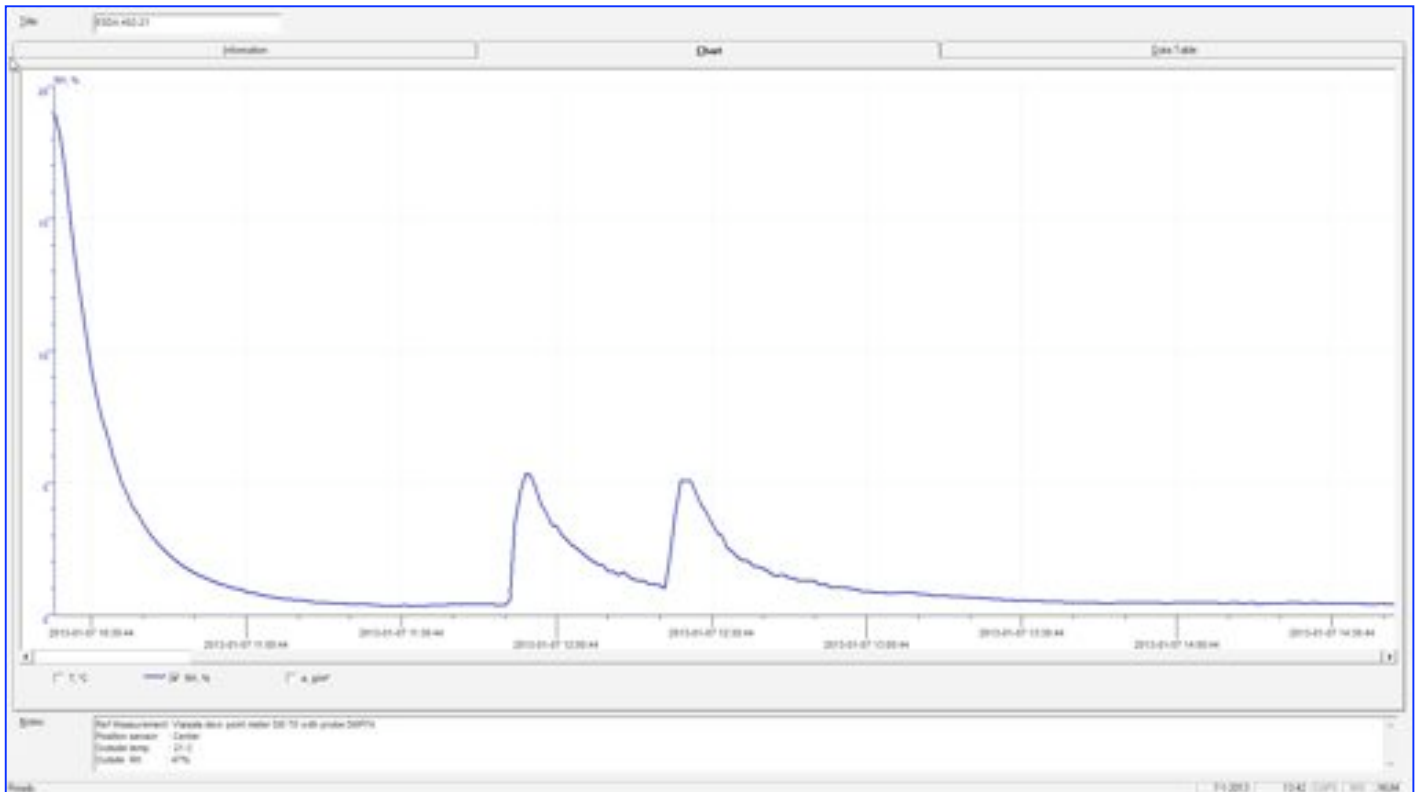

Test conditions



Instrument:
 Type of dew point sensor:
 Accuracy of dew point sensor:
 Location of sensor:
 Ambient conditions:
 Door openings:

Vaisala.
 Vaisala drycap 180M
 $\pm 0.2^\circ \text{C}$ at $+ 20^\circ \text{C}$ ($+ 68^\circ \text{F}$)
 In the direct surrounding of cabinet sensor
 Humidity $50 \pm 5\% \text{ RH}$, $25^\circ \pm 2^\circ \text{C}$, Pressure $994 \pm 20 \text{ hPa}$.
 2 door openings, 15 sec. (average RH 0.70%)



Technical Dimensions

ESDA 402-21

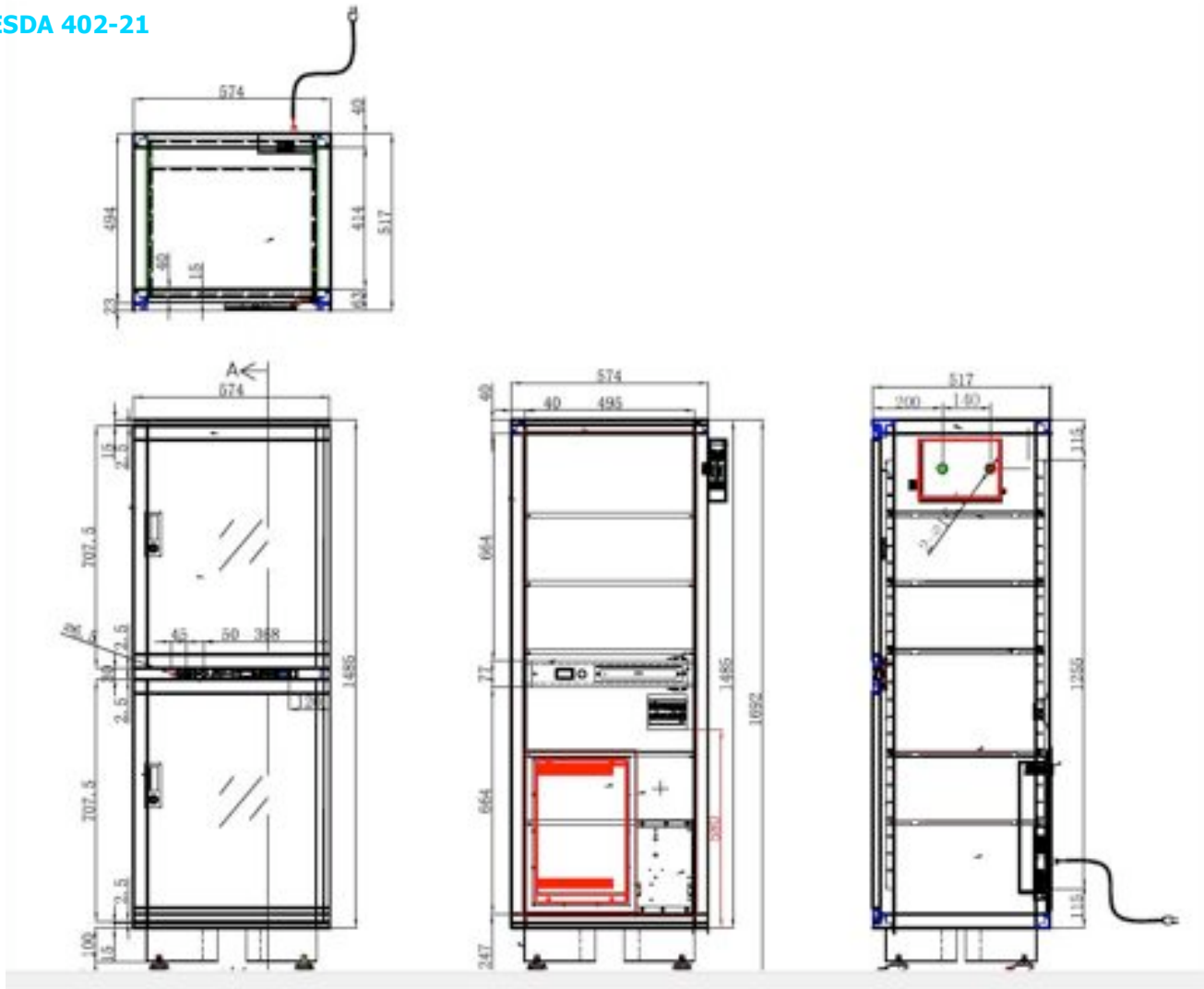

Dimensions in mm

Maximum number of shelves that can be mount in the cabinet	17 long shelves, 7 short shelves
Minimum space between the shelves	35 mm



Options



N2 Auto Flow System

The Auto Flow System is developed for use in combination with a Totech drying cabinet. The device is used for the quick removal of moisture in the cabinet after the doors have been opened. The drying process is realized by using nitrogen (N²), which is added automatically after the doors have been closed (by means of adjustable timer function)

Item number 22613001



SMD reel holders,

460 mm length, and mountable on shelf.

Item number 20014000

SMD reel supports

Reel support for 2001400

Item number 20014200



Rotronic datalogger set

Including HW4-E-V3 Software and Cable AC3006

Item number 47000580



Humidity calibrator Hygropalm 22

Precision measuring device for calibrating sensors

Set includes Hygroclip sensor, case and cable

Item number 20001019

Hygropalm only

Item number 20001016



Shelf ESDA-402 - short incl. brackets

Item number 30010100



Shelf ESDA-402- long incl. brackets

Item number 20100021

version 14-01

