

# Wiha SYSTEM 6 ESD.

The Compact Allrounder.

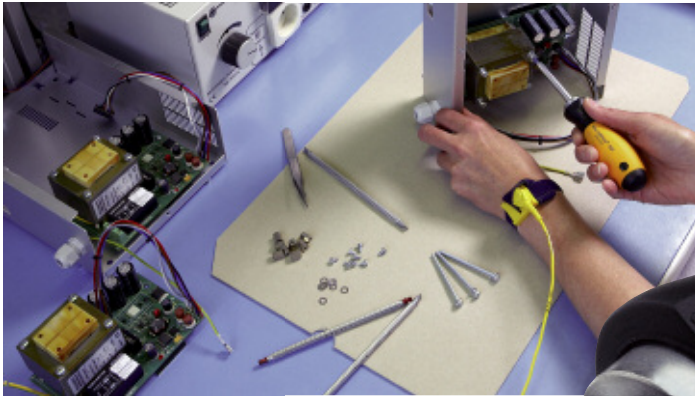

## Wiha SYSTEM 6:

- Flexible & versatile tools in industrial quality
- Dissipative handle designed to discharge uniformly, surface resistance  $10^6 - 10^9 \text{ Ohm}$
- Fulfils the ESD standard IEC 61340-5-1
- Ergonomic SoftFinish® multi-component handle guarantees comfortable work and optimised handling
- Colour-coded blades made of high-quality, tough chrome-vanadium-molybdenum steel, through-hardened, chrome-plated
- Wiha ChromTop® tips ensure a perfect fit every time

### Safety Notice:

Wiha ESD screwdrivers are non-insulated, therefore not suitable for working on live parts.

### SYSTEM 6 Handle.



284ESD

SYSTEM 6 SoftFinish®-telescopic ESD Handle.  
Dissipative Handle, ESD-safe.

Handle: Ergonomic multi-component handle with roll-off protection. With 6 mm hex retainer. Enables adjustable blade lengths from 42-114 mm. ClickStop ball clamp guarantees a secure hold and rapid blade exchange. Surface resistance  $10^6 - 10^9 \text{ Ohm}$ .

Standards: IEC 61340-5-1.

Application: For working on electrostatically sensitive components.

Order-No.	6.0	115	36	5
31496 5				

# Wiha SYSTEM 6 ESD.

The Compact Allrounder.

## SYSTEM 6 Reversible Blades.



### 284 SYSTEM 6 Slotted Reversible Blade.

Blade: High quality chrome-vanadium-molybdenum steel, through hardened, chrome-plated.  
Colour-coded Wiha ChromTop® tips.

Order-No.	⊖	⊕	⊖	⊕	↔	⦿	⦿
27627 0	3.5	4.5	0.6	0.8	150	6.0	5
00629 7	4.0	6.0	0.8	1.0	150	6.0	5
00630 3	5.5	6.5	1.0	1.2	150	6.0	5



### 284 SYSTEM 6 Combined Slotted-Phillips Reversible Blade.

Blade: High quality chrome-vanadium-molybdenum steel, through hardened, chrome-plated.  
Colour-coded Wiha ChromTop® tips.

Order-No.	⊖	⊕	⊖	⊕	↔	⦿	⦿
00665 5	4.0	PH1	0.8	150	6.0	5	
00666 2	6.0	PH2	1.0	150	6.0	5	
00667 9	6.5	PH3	1.2	150	6.0	5	



### 284 SYSTEM 6 Phillips Reversible Blade.

Blade: High quality chrome-vanadium-molybdenum steel, through hardened, chrome-plated.  
Colour-coded Wiha ChromTop® tips.

Order-No.	⊕	⊕	↔	⦿	⦿
00631 0	PH1	PH2	150	6.0	5
27628 7	PH2	PH3	150	6.0	5



### 284 SYSTEM 6 Pozidriv Reversible Blade.

Blade: High quality chrome-vanadium-molybdenum steel, through hardened, chrome-plated.  
Colour-coded Wiha ChromTop® tips.

Order-No.	⊕	⊕	↔	⦿	⦿
00632 7	PZ1	PZ2	150	6.0	5
27629 4	PZ2	PZ3	150	6.0	5

## SYSTEM 6 Reversible Blades.



### 284 SYSTEM 6 Combined Ballpoint Hex-Hex Reversible Blade.

Blade: High quality chrome-vanadium-molybdenum steel, through hardened, chrome-plated.  
Colour-coded Wiha ChromTop® tips.  
Extra: The ballpoint enables the user to work at angles up to 25°.

Order-No.	⦿	⦿	↔	⦿	⦿
00635 8	2.5	2.5	150	6.0	5
00636 5	3	3	150	6.0	5
00637 2	4	4	150	6.0	5
00638 9	5	5	150	6.0	5
00639 6	6	6	150	6.0	5



### 284 SYSTEM 6 TORX® Reversible Blade.

Blade: High quality chrome-vanadium-molybdenum steel, through hardened, chrome-plated.  
Colour-coded Wiha ChromTop® tips.

Order-No.	⦿	⦿	↔	⦿	⦿
00654 9	T6	T8	150	6.0	5
00655 6	T7	T9	150	6.0	5
00656 3	T10	T15	150	6.0	5
00657 0	T20	T25	150	6.0	5
00658 7	T30	T40	150	6.0	5



### 284 SYSTEM 6 TORX® Tamper Resistant Reversible Blade. For TORX® Screws with Locking Pin.

Blade: High quality chrome-vanadium-molybdenum steel, through hardened, chrome-plated.  
Colour-coded Wiha ChromTop® tips.  
With borehole in the blade tip.

Order-No.	⦿	⦿	↔	⦿	⦿
27630 0	T6H	T8H	150	6.0	5
27631 7	T7H	T9H	150	6.0	5
27632 4	T10H	T15H	150	6.0	5
27633 1	T20H	T25H	150	6.0	5
27634 8	T30H	T40H	150	6.0	5

#### Safety Notice:

Wiha ESD screwdrivers are non-insulated, therefore not suitable for working on live parts.

## SYSTEM 6 Reversible Blade, Bit Holder, Adapter.



### 284 SYSTEM 6 Tri-Wing® Reversible Blade. For Tri-Wing® Security Screws.

Blade: High quality chrome-vanadium-molybdenum steel, through hardened, chrome-plated.  
Colour-coded Wiha ChromTop® tips.

Order-No.	⦿	⦿	↔	⦿	⦿
27637 9	TW0	TW1	150	6.0	5
27638 6	TW2	TW3	150	6.0	5
27639 3	TW4	TW5	150	6.0	5



### 284 SYSTEM 6 Torq-Set® Reversible Blade. For Torq-Set® Security Screws.

Blade: High quality chrome-vanadium-molybdenum steel, through hardened, chrome-plated.  
Colour-coded Wiha ChromTop® tips.

Order-No.	⦿	⦿	↔	⦿	⦿
27635 5	TS2	TS4	150	6.0	5
27636 2	TS6	TS8	150	6.0	5



### 7802 SYSTEM 6 Bit Holder.

Suitable for C 6.3 and E 6.3 (1/4") Bits.  
Blade: Chrome-vanadium steel, through hardened, chrome-plated.  
Bit retainer made of stainless steel with integrated permanent magnet.

Order-No.	⦿	↔	⦿	⦿	⦿
03882 3	1/4	164	6.0	10	5



### 7803 SYSTEM 6 Adapter Blade. Suitable for 1/4" Square Sockets.

Blade: Chrome-vanadium steel, through hardened, chrome-plated.  
1/4" square drive with ball retainer.

Order-No.	⦿	↔	⦿	⦿	⦿
03883 0	1/4	164	6.0	5	



### U109 00 SYSTEM 6 Extension Blade. Suitable for Blades.

Blade: Chrome-vanadium steel, through hardened, chrome-plated.  
Extends all SYSTEM 6 blades up to 100 mm.

Order-No.	⦿	↔	⦿	⦿	⦿
08921 4	6.0	166	6.0	11	5

## Starter-Set.



### 284ESD T6 01 SYSTEM 6 ESD Set of Reversible Blades, 6 pcs. Slotted/ Phillips/ Hex/ Ballpoint Hex.

Blade: High quality chrome-vanadium-molybdenum steel, through hardened, chrome-plated.  
Colour-coded Wiha ChromTop® tips.  
Blade length is adjustable from 42-114 mm.  
Handle: SYSTEM 6 SoftFinish®-telescopic ESD handle.  
ESD-safe (dissipative), surface resistance 10<sup>6</sup> - 10<sup>9</sup> Ohm.  
ClickStop ball clamp guarantees a secure hold and rapid blade exchange.  
Extra: Versatile and space-saving, fits in every toolbox.

Order-No.	Series	⦿
31497 2	284ESD T6 01	1
⊖	284ESD	SYSTEM 6 SoftFinish®-telescopic ESD handle
⊖	284	3.5 - 4.5 4.0 - 6.0 5.5 - 6.5
⊕	284	PH1 - PH2
⦿	284	5 - 5

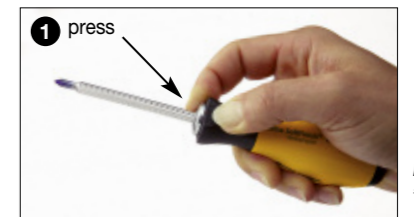

Press sleeve:  
=> Blade locking is released

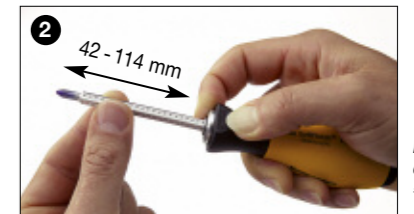

Press and hold down sleeve:  
=> Set desired blade length



Release sleeve:  
=> Blade is held securely