

Soldering Tools and Equipment

Product Catalog 2010



Soldering/Desoldering

Convection Rework

Fume Extraction

Fluid Dispensing



KREPRO

www.krepro.no

OKI

www.beasuperproducer.com

HCT-1000 Programmable Hand Held Convection Tool



The HCT-1000 is a fully Programmable Hand Held Convection Tool offering **fast and easy removal and placement of SMT components**.

The HCT-1000 stands out as a versatile convection rework tool. It can be used on its own or as part of the MRS-1000 Modular Rework System for more complex applications.

The system comes equipped with a 5mm nozzle and nozzle adapter. In addition, a wide range of nozzles is available, see page 22.

Key Features & Benefits

- ▶ Integrated vacuum pickup for easy component removal
- ▶ Profile creation for operator repeatability and storage for up to 50 user defined profiles
- ▶ Manual mode for quick setup
- ▶ External thermocouple for process setup and verification
- ▶ Hand-piece controls for heater and vacuum
- ▶ Programmable, digitally controlled airflow for repeatable results
- ▶ Multiple modes of operation: manual, 4 zone heating (with the MRS-1000 System)
- ▶ The HCT-1000 is connected to the PCT-1000 via a cable when used as part of the MRS System
- ▶ May be used with ATH-1000 Adjustable Tool Holder (see page 24)

Part No.	Description
HCT-1000	Programmable Hand Held Convection Tool
Includes:	
HCT-PS1000	HCT-1000 Power Supply
HCT-HV1	Hand-piece with integral vacuum, cord and connector
HCT-FS2	Footswitch, Dual, HCT-1000
HCTA-VC50-5	Vacuum Cup, 3/16" (5.00mm), pack of 5
HCTA-VC64-5	Vacuum Cup, 1/4" (6.4mm), pack of 5
HCTA-VC80-5	Vacuum Cup, 5/16" (8mm), pack of 5
HCTA-VC11-5	Vacuum Cup, 7/16" (11mm), pack of 5
HCTA-TH1	Hand-piece Tool Holder
AC-TCK-24-36	Thermocouple
HCTA-CC	Communications Cable
HCT-HTRASSY	Heater Assembly

Technical Specifications

Size	229 x 178 x 152mm (9" x 7" x 6")
Weight	5.4kg (12 lbs.)
Rated Power	600 W
Input Voltage	100-240 VAC, 50/60 Hz
Storage	0°C to 50°C Temperature (32°F to 122°F)
Air Flow	5-25 l/minute
Temperature Range	Up to 450°C (840°F)
Vacuum Pump	15" Hg (381mm Hg)
Noise Level	<55 dB

HCT-1000 Programmable Hand Held Convection Tool

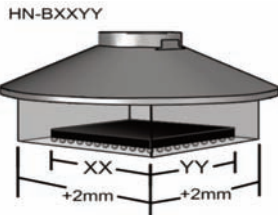

HN Series Nozzles

A series of 14 Nozzles are available for use with the MRS-1000 / HCT-1000. The nozzles fit applications reworking components of all sizes from (including, but not limited to) BGAs, QFPs, LGAs, PLCC and SOIC. A custom nozzle program is also available.

Nozzle Measurement and Selection

The nozzle part number (the digits after the “B”) represents the size of the component. 2mm have been added to each side of the internal nozzle dimension to allow for component access.

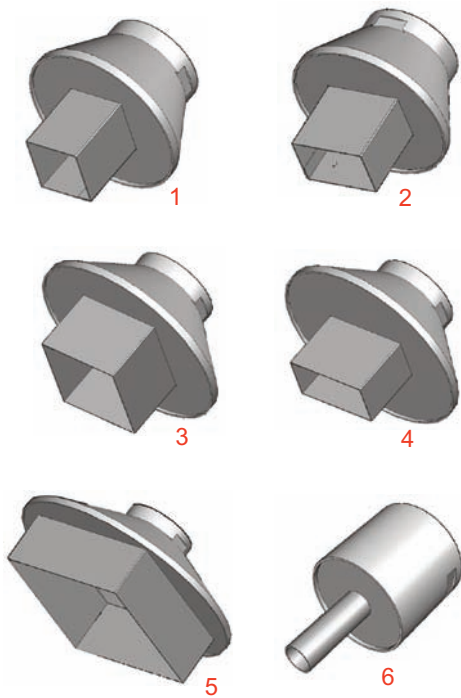

Part Number	Component Size	Components
HN-B0707	1 7mm X 7mm	CSP, LGA44
HN-B1010	1 10mm X 10mm	CSP, LGA178, LCC28
HN-B1414	1 14mm X 14mm	CSP, QFP, TQFP100
HN-B1408	2 14mm X 8mm,	CSP, SOIC24M
HN-B1515	3 15mm X 15mm	BGA
HN-B1818	3 18mm X 18mm	PLC44, CSP, TQFP100, BGA
HN-B2525	3 25mm x 25mm	BGA, PLCC68
HN-B1809	4 18.2mm X 8.5mm	SOLJ28, SOIC28M, TSOP32
HN-B2519	4 24.5mm X 18.5mm	QFP100, QFP80
HN-B2727	5 27mm X 27mm	BGA
HN-B3232	5 32mm X 32mm	BGA
HN-B3535	5 35mm X 35mm	BGA
HN-B4040	5 40mm X 40mm	BGA
HN-J0005	6 5mm Ø Diameter	DISCRETE

Other Nozzle Accessories for HCT-1000

HCT-NC	7	Nozzle Carrier
HNA-1	8	Nozzle Adapter
HCTA-NW1	9	Nozzle Wrench



ATH-1000 Adjustable Tool Holder



Key Features & Benefits

- ▶ Adjustable Tool Holder designed to work as stand-alone operation or integrated as part of the MRS-1000
- ▶ Consists of a board holder, locking hand-piece retainer, Z axis stop and mounting configurations
- ▶ Sturdy and easy to attach to the PCT-1000 when incorporated into the MRS System.

Two Adjustable Tool Holder models are available:

- ▶ The **ATH-1000A** uses the Advanced Head Assembly which features 4" of Z axis adjustment, ½" fine adjustment of the X & Y axis as well as 30° θ adjustment.
- ▶ The **ATH-1000B** uses the Basic Head assembly and provides 4" of Z axis adjustment.

Part No.	Description
ATH-1000A	Adjustable Tool Holder, Advanced Head (without base plate)*
ATH-1000B	Adjustable Tool Holder, Basic Head (without base plate)*
ATH-RAIL-12	Board Holder Rail for ATH-1000, 12"
	¹ Both ATH-1000A and ATH-1000B are supplied with an 8" rail as standard (ATH-RAIL-8).
ATH-BASE	² Base assembly for ATH-1000A and ATH-1000B

* As part of the MRS-1000, the ATH-1000 is attached to the back of the PCT-1000, see page 23. The ATH-BASE can be ordered separately when the ATH-1000 is used as a stand-alone unit.

LM-1000 Light Magnifier



Key Features & Benefits

- ▶ Integrated light and magnifier
- ▶ 4x magnification lens
- ▶ Integrated LED lighting system for shadow free illumination
- ▶ Can be used with the MRS System or as standalone operation

Part No.	Description
LM-1000	³ Light Magnifier (without base plate)*
LM-BP	⁴ Base Plate for Light Magnifier

* As part of the MRS-1000, the LM-1000 is attached to the back of the PCT-1000, see page 23. The LM-BP can be ordered separately when the LM-1000 is used as a stand-alone unit.

Technical Specifications

Weight	2.9kg (6.5 lbs)
Magnification	4x
Lighting	8 LEDs, white
Power	24V DC

Board Holders for PCT-1000 & PCT-100 Pre-heaters

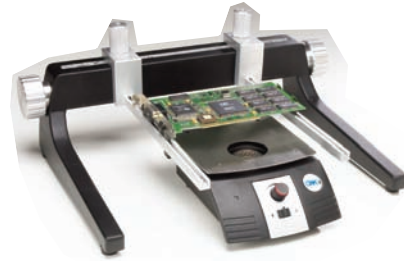

BH-100 Board Holder. Recommended for use with the PCT-100 Pre-heater



BH-1000 Post-Rail Board Holder. Includes: 4 posts, 2 rails with sliding clips, 4 support pins and flat-head support

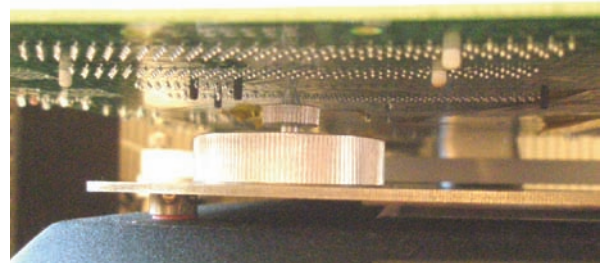

BH-PK1000 Board Holder Pin Kit. Includes: 2 discs, 2 long pins, 2 short pins



ATH-1000(A or B) + ATH-BASE

ATH-1000(A or B) + PCT-1000

A = Advanced Head - B = Basic Head

